

MML3-ST65DS / ST65S

SCHOTT MORITEX Reference
Data do not guarantee the performance of the product

MML-Standard

Drawing No. A03839/A03952



レンズ形式	Lens Type	Fixed Magnification Object Side Telecentric Lens
光学倍率	Magnification	3.00
焦点距離 (mm)	Focal Length	13.07
有効Fno	Effective Fno	21.90
NA	Numerical Aperture	0.069
WD/OD (mm)	Working/Object Distance	65.0/67.0
O/I (mm)	Object to Image Distance	141.98
鏡筒長 (mm)	Mechanical Tube Length	59.50
レンズバック (mm)	Lens Back	30.35
被写界深度 (mm)	DOF @PCoC $\phi 0.04\text{mm}$	0.190
分解能 (μm)	Resolution @ $\lambda=550\text{nm}$	4.7
前側/後側主点位置 (mm)	Front/Rear Principal Position	-49.57/-21.77
入射/出射瞳位置 (mm)	Entrance/Exit Pupil Position	-1,195.95/-8.55
入射/出射瞳径 (mm)	Entrance/Exit Pupil Diameter	155.51/1.79
テレセントリシティー (deg.)	Telecentricity	0.051(1/3Inch) 0.068(1/2Inch)
光学ディストーション (%)	Optical Distortion	0.013(1/3Inch) 0.016(1/2Inch)
周辺光量比 (%)	Relative Illumination	99.81(1/3Inch) 99.13(1/2Inch)
質量 (g)	Weight	35.0/30.0
マウント	Mount	C Mount
イメージサークル径 (mm)	Image Circle	$\phi 8$
最大適合カメラ	Largest Compatible Camera	1/2 Inch

MML3-ST65DS

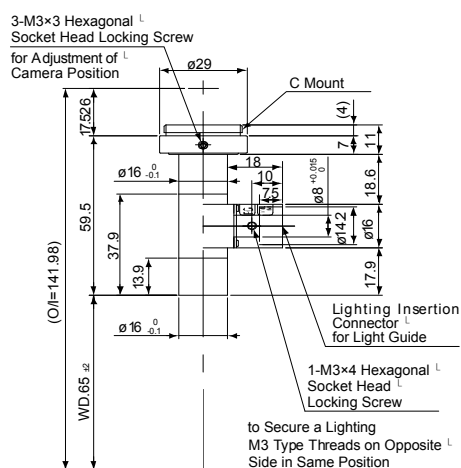

MML3-ST65S

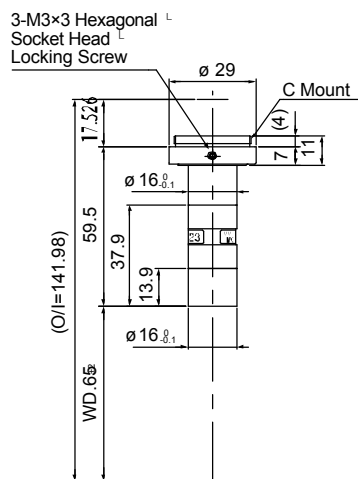

SCHOTT MORITEX Reference
Data do not guarantee the performance of the product

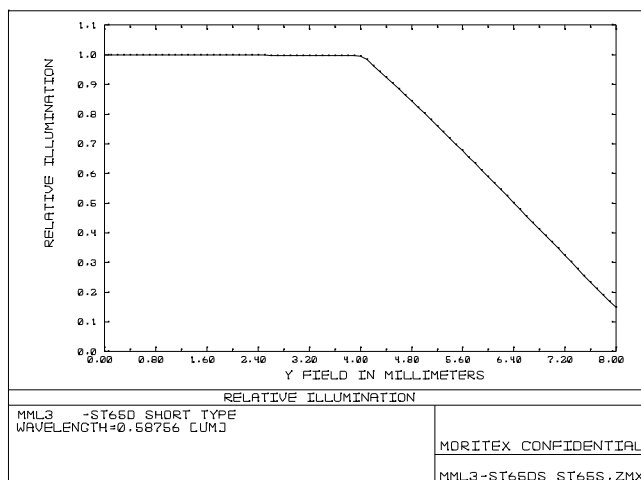
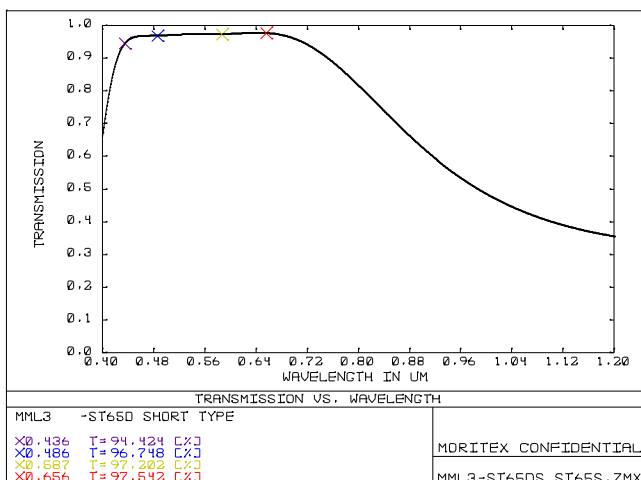
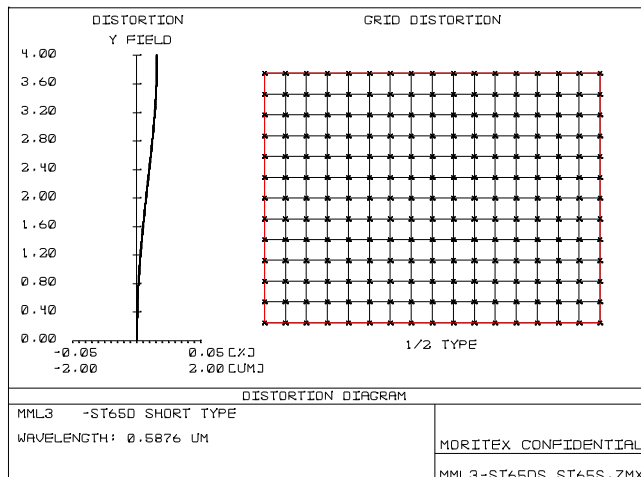
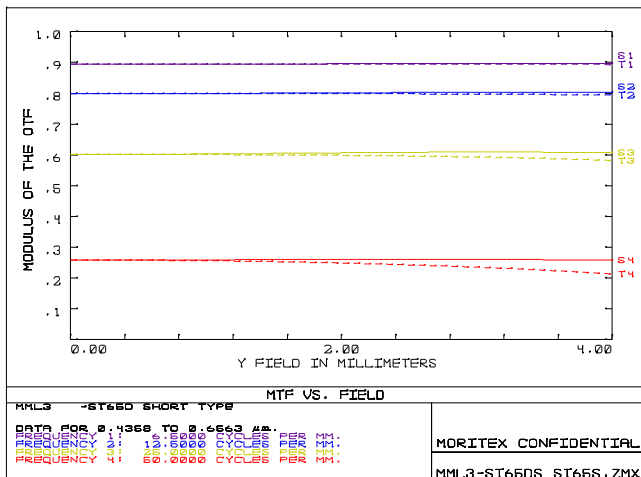

内容は、通知なしに随時変更されることがあります。

The content is subject to change at any time without notification.