

# MML1.5-ST65D / ST65

**SCHOTT MORITEX Reference**  
Data do not guarantee the performance of the product

## MML-Standard

Drawing No. A03679/A03678



レンズ形式	Lens Type	Fixed Magnification Object Side Telecentric Lens
光学倍率	Magnification	1.50
焦点距離 (mm)	Focal Length	503.40
有効Fno	Effective Fno	15.50
NA	Numerical Aperture	0.048
WD/OD (mm)	Working/Object Distance	65.0/67.5
O/I (mm)	Object to Image Distance	157.20
鏡筒長 (mm)	Mechanical Tube Length	74.60
レンズバック (mm)	Lens Back	16.85
被写界深度 (mm)	DOF @PCoC $\phi 0.04\text{mm}$	0.560
分解能 ( $\mu\text{m}$ )	Resolution @ $\lambda=550\text{nm}$	7.0
前側/後側主点位置 (mm)	Front/Rear Principal Position	771.59/-1,241.85
入射/出射瞳位置 (mm)	Entrance/Exit Pupil Position	-15,998,749.54/-738.38
入射/出射瞳径 (mm)	Entrance/Exit Pupil Diameter	1,540,710.39/48.48
テレセントリシティー (deg.)	Telecentricity	0.001(1/3Inch) 0.003(1/2Inch)
光学ディストーション (%)	Optical Distortion	-0.055(1/3Inch) -0.109(1/2Inch)
周辺光量比 (%)	Relative Illumination	99.77(1/3Inch) 99.60(1/2Inch)
質量 (g)	Weight	43.0/36.0
マウント	Mount	C Mount
イメージサークル径 (mm)	Image Circle	$\phi 8$
最大適合カメラ	Largest Compatible Camera	1/2 Inch

### MML1.5-ST65D

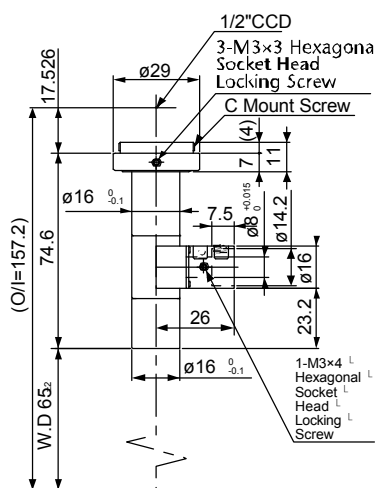

### MML1.5-ST65

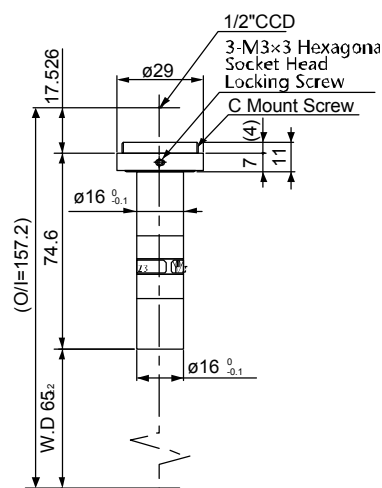

**SCHOTT MORITEX Reference**  
Data do not guarantee the performance of the product

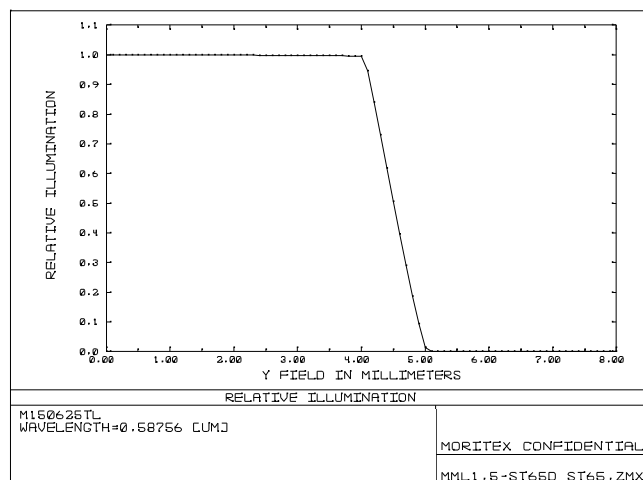
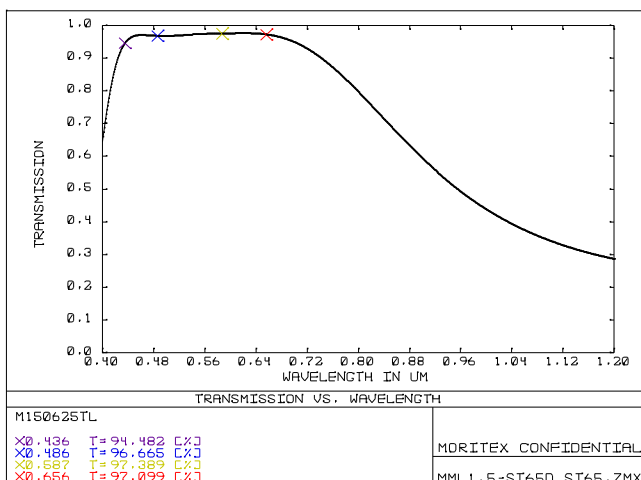
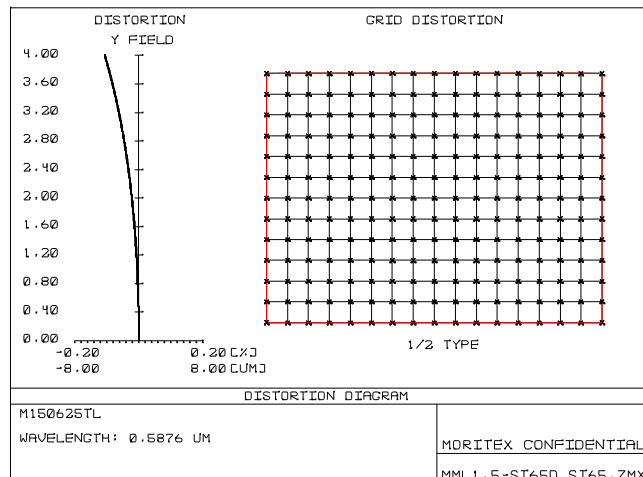
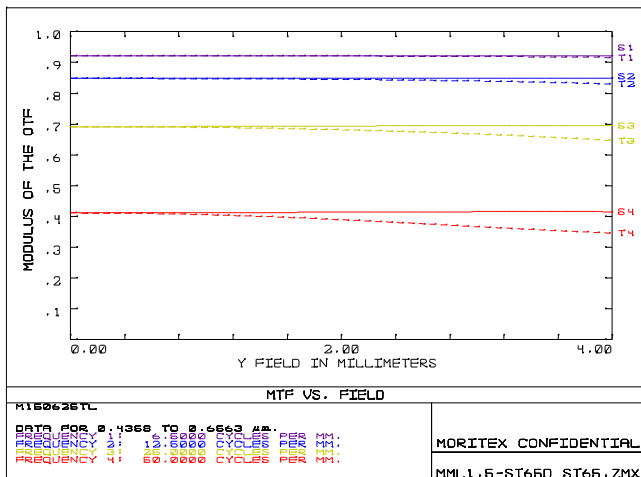

内容は、通知なしに随時変更されることがあります。

The content is subject to change at any time without notification.