

MML1.5-HR65D / HR65

SCHOTT MORITEX Reference
Data do not guarantee the performance of the product

MML-High Resolution

Drawing No. A03179/A03499



レンズ形式	Lens Type	Fixed Magnification Object Side Telecentric Lens
光学倍率	Magnification	1.50
焦点距離 (mm)	Focal Length	503.40
有効Fno	Effective Fno	12.00
NA	Numerical Aperture	0.063
WD/OD (mm)	Working/Object Distance	65.0/67.5
O/I (mm)	Object to Image Distance	157.20
鏡筒長 (mm)	Mechanical Tube Length	74.60
レンズバック (mm)	Lens Back	16.86
被写界深度 (mm)	DOF @PCoC $\phi 0.04\text{mm}$	0.420
分解能 (μm)	Resolution @ $\lambda=550\text{nm}$	5.4
前側/後側主点位置 (mm)	Front/Rear Principal Position	771.59/-1,241.85
入射/出射瞳位置 (mm)	Entrance/Exit Pupil Position	-15,998,749.54/-738.38
入射/出射瞳径 (mm)	Entrance/Exit Pupil Diameter	1,984,434.98/62.45
テレセントリシティー (deg.)	Telecentricity	0.001(1/3Inch) 0.003(1/2Inch)
光学ディストーション (%)	Optical Distortion	-0.056(1/3Inch) -0.110(1/2Inch)
周辺光量比 (%)	Relative Illumination	99.76(1/3Inch) 99.59(1/2Inch)
質量 (g)	Weight	53.0/46.0
マウント	Mount	C Mount
イメージサークル径 (mm)	Image Circle	$\phi 8$
最大適合カメラ	Largest Compatible Camera	1/2 Inch

MML1.5-HR65D

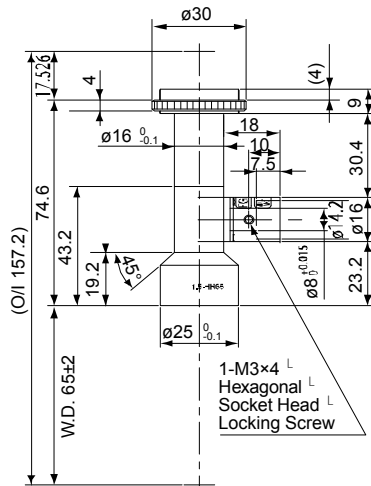

MML1.5-HR65

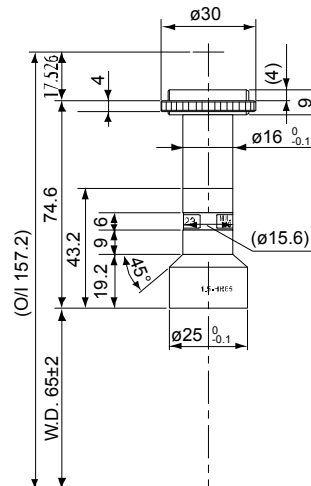

SCHOTT MORITEX Reference
Data do not guarantee the performance of the product

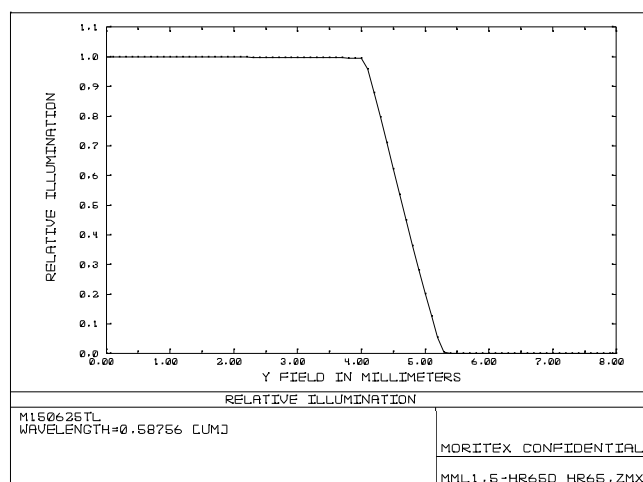
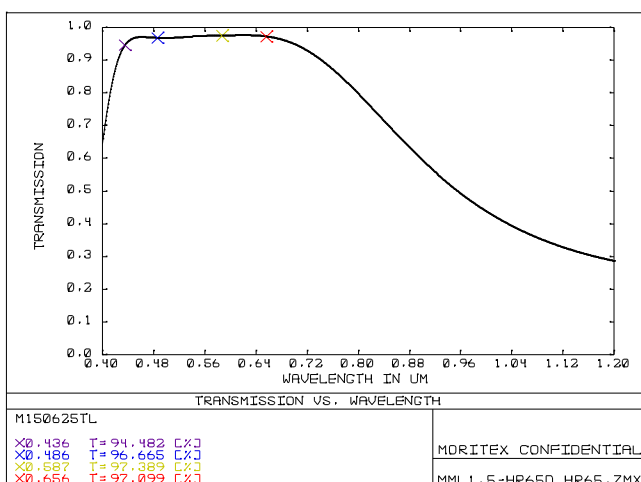
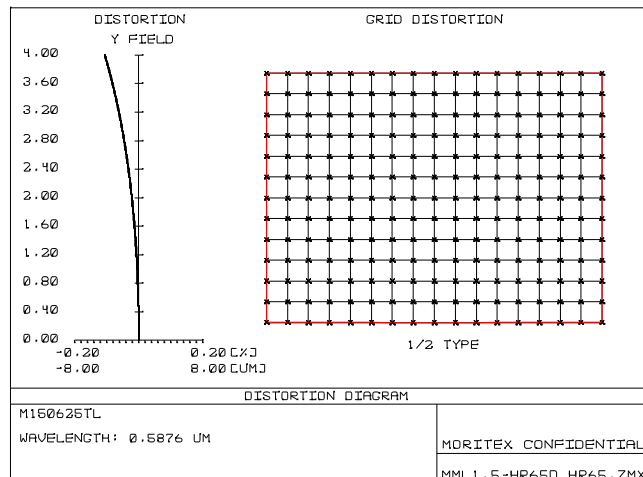
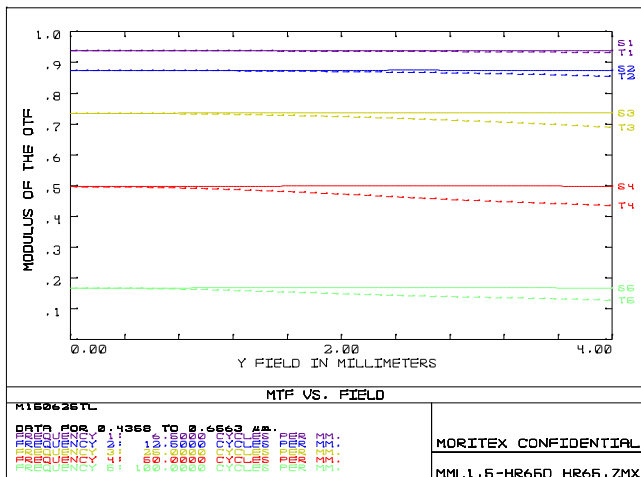

内容は、通知なしに随時変更されることがあります。

The content is subject to change at any time without notification.