

# MML08-HR255D / HR255

**SCHOTT MORITEX Reference**  
Data do not guarantee the performance of the product

## MML-High Resolution

Drawing No. A21300/A21486



レンズ形式	Lens Type	Fixed Magnification Object Side Telecentric Lens
光学倍率	Magnification	0.80
焦点距離 (mm)	Focal Length	46.73
有効Fno	Effective Fno	10.13
NA	Numerical Aperture	0.040
WD/OD (mm)	Working/Object Distance	255.7/257.4
O/I (mm)	Object to Image Distance	385.90
鏡筒長 (mm)	Mechanical Tube Length	112.70
レンズバック (mm)	Lens Back	27.08
被写界深度 (mm)	DOF @PCoC $\phi$ 0.04mm	1.266
分解能 ( $\mu$ m)	Resolution @ $\lambda=550$ nm	8.5
前側/後側主点位置 (mm)	Front/Rear Principal Position	-152.22/-57.23
入射/出射瞳位置 (mm)	Entrance/Exit Pupil Position	2507.29/-11.30
入射/出射瞳径 (mm)	Entrance/Exit Pupil Diameter	219.42/3.79
テレセントリシティー (deg.)	Telecentricity	0.078(1/3Inch) 0.105(1/2Inch) 0.117(1/1.8Inch) 0.146(2/3Inch)
光学ディストーション (%)	Optical Distortion	0.125(1/3Inch) 0.219(1/2Inch) 0.269(1/1.8Inch) 0.402(2/3Inch)
周辺光量比 (%)	Relative Illumination	99.10(1/3Inch) 98.41(1/2Inch) 98.04(1/1.8Inch) 97.03(2/3Inch)
質量 (g)	Weight	150.0/145.0
マウント	Mount	C Mount
イメージサークル径 (mm)	Image Circle	$\phi$ 11
最大適合カメラ	Largest Compatible Camera	2/3 Inch

MML08-HR255D

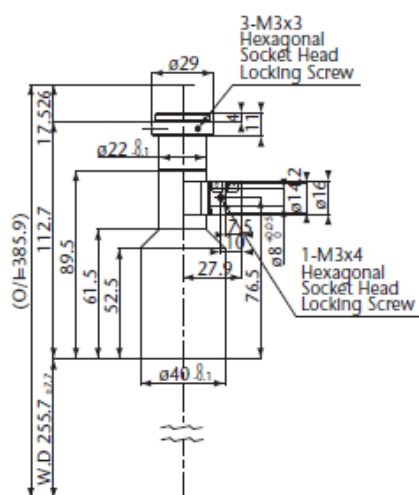

MML08-HR255

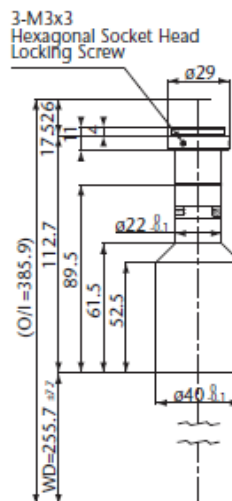

**SCHOTT MORITEX Reference**  
Data do not guarantee the performance of the product

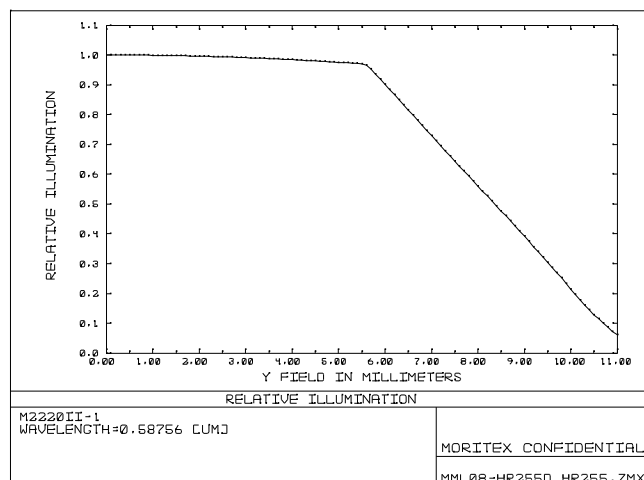
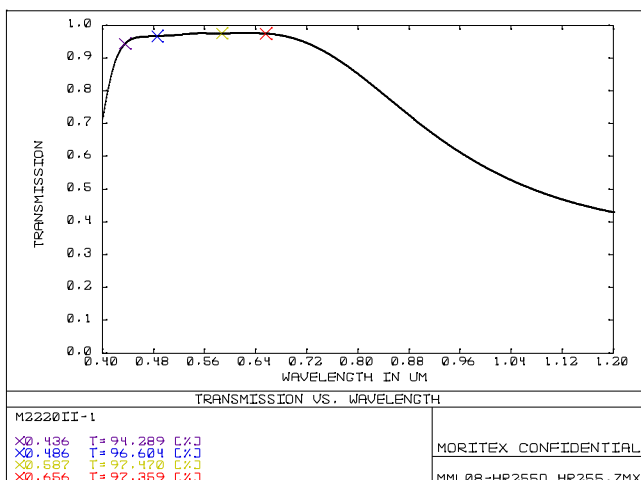
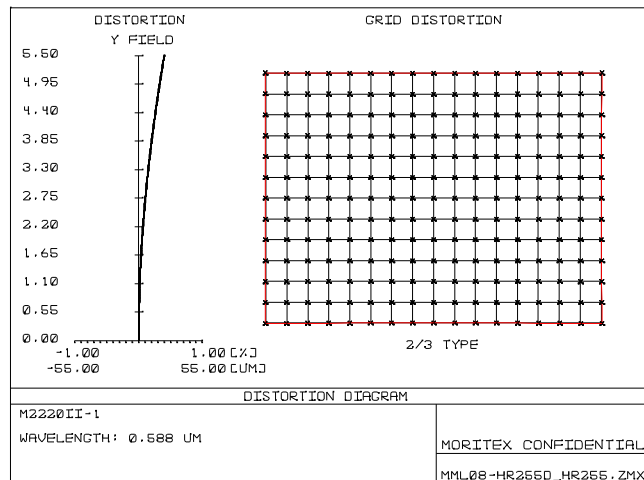
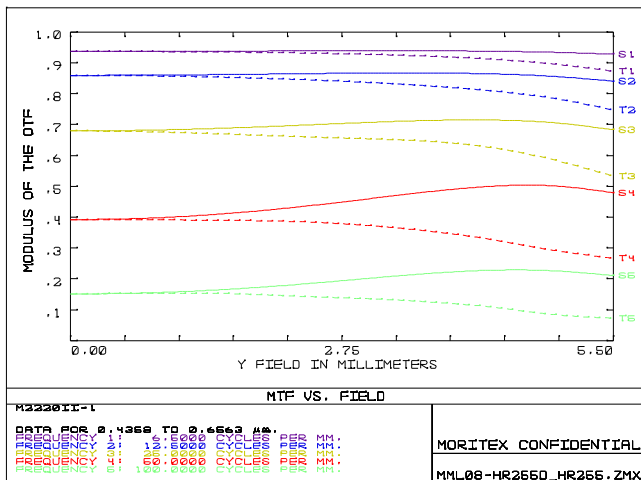

内容は、通知なしに随時変更されることがあります。

The content is subject to change at any time without notification.